

CONSTRUCTION NOTE:

1. SAW CUT ALONG EXISTING CONSTRUCTION JOINTS (AS SHOWN ON PLAN).
2. DEMO AND REMOVE APPROXIMATELY 5316 SF OF CONCRETE SIDEWALK PUBLIC. 3822 SF OF CONCRETE SIDEWALK LBR.
3. ALL EXISTING BOLLARD POST & CHAIN TO BE REMOVED.
4. INSTALL CONCRETE SIDEWALK. SIDEWALK TO BE 6 SACK MIX WITH 6" MIN. DEPTH (LIGHT BROOM FINISH)

GENERAL NOTE:

1. WORK AREA TO BE SECURED AT ALL TIMES RESTRICTING ACCESS FROM ALL PEDESTRIAN TRAFFIC.
2. AREA AROUND THE WORK AREA MUST BE KEPT CLEAN AND SAFELY ACCESSIBLE FOR PEDESTRIAN AND BUSINESS TRAFFIC.

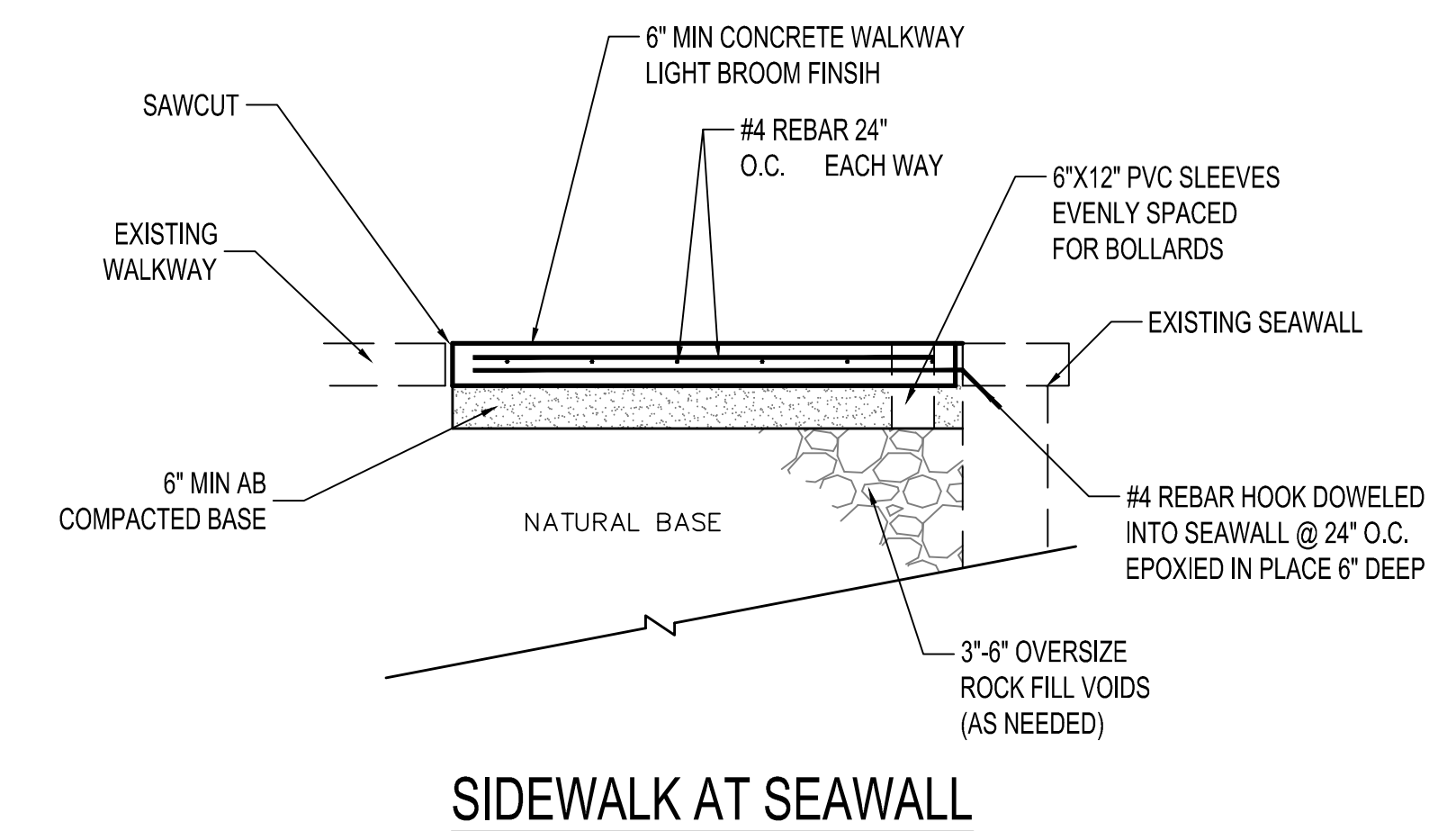

NO.	REVISIONS / SUBMISSIONS	DATE
#	-	-
#	-	-
#	-	-
#	-	-

**BRIDGEWATER CHANNEL
SIDEWALK REPLACEMENT
@ STAGE AREA**

Designed by:	GSH
Drawn by:	GSH
Checked by:	INT
Date:	10/28/22
Dwg. scale:	1"=10'

SIDEWALK AREA

Sheet Number:

X-100

Sheet 1 of 1