

REQUIREMENTS  
FOR  
RESIDENTIAL  
POOL AND SPA SUBMITTAL



"Build a good city by guiding the orderly physical development of Lake Havasu City in accordance with the General Plan and the community development codes and policies adopted by the City Council"

# RESIDENTIAL POOL AND SPA REQUIREMENTS

ALL PLANS SHALL BE DRAWN TO SCALE AND MUST BE LEGIBLE

## SITE PLAN

- Show the shape of the lot, property line dimensions, easement locations, pool location, width and depth of pool and/or spa. Health department approval shall be provided if applicable and the estimated project value shall also be provided.
- Show location of all existing buildings and the distance between the pool and/or spa and structures. (Pool and/or spa shall be located a distance equal to the depth of the pool and/or spa from the edge of a building footing. If this distance cannot be achieved then structural engineering shall be provided for the footing surcharge on the pool.)
- Distance from overhead or underground electrical service to pool and/or spa shall be shown. (10 foot minimum horizontal distance to overhead service and 5 foot minimum distance to underground service.)
- Show location of all retaining walls and the distance between the pool and/or spa and the wall. (If the retaining wall is supporting fill dirt in which the pool and/or spa is located, the minimum horizontal separation from the outside face of the retaining wall to the inside face of the pool and/or spa shell shall be 10 feet. If the pool and/or spa is located closer than 10 feet, then the pool and/or spa shall be engineered to be self-supporting. If the pool and/or spa is located on the non-retaining wall side, then the pool shall be located the depth of the pool away from retaining wall or engineered pool design shall be provided for surcharge.)
- Show all slope locations and distance between the pool and/or spa and slope. (If pool is located closer than 7 feet to the top of a slope, then the pool and/or spa shall be engineered to be self-supporting. If the pool and/or spa is located at the toe of a slope, then the pool and/or spa shall be setback from the toe of slope one half the vertical height of the slope.)
- Pool and/or spa equipment and decking shall be shown on the site plan. (If the equipment or decking is located in the Public Utility Easement, then easement encroachment forms shall be submitted granting approval.)
- If a gas heater is going to be installed, plans must specify the size of the heater in BTU's, length and size of the gas line from the meter to pool and/or spa heater. (Propane gas lines are approved and permitted by the Fire Marshal's office.)

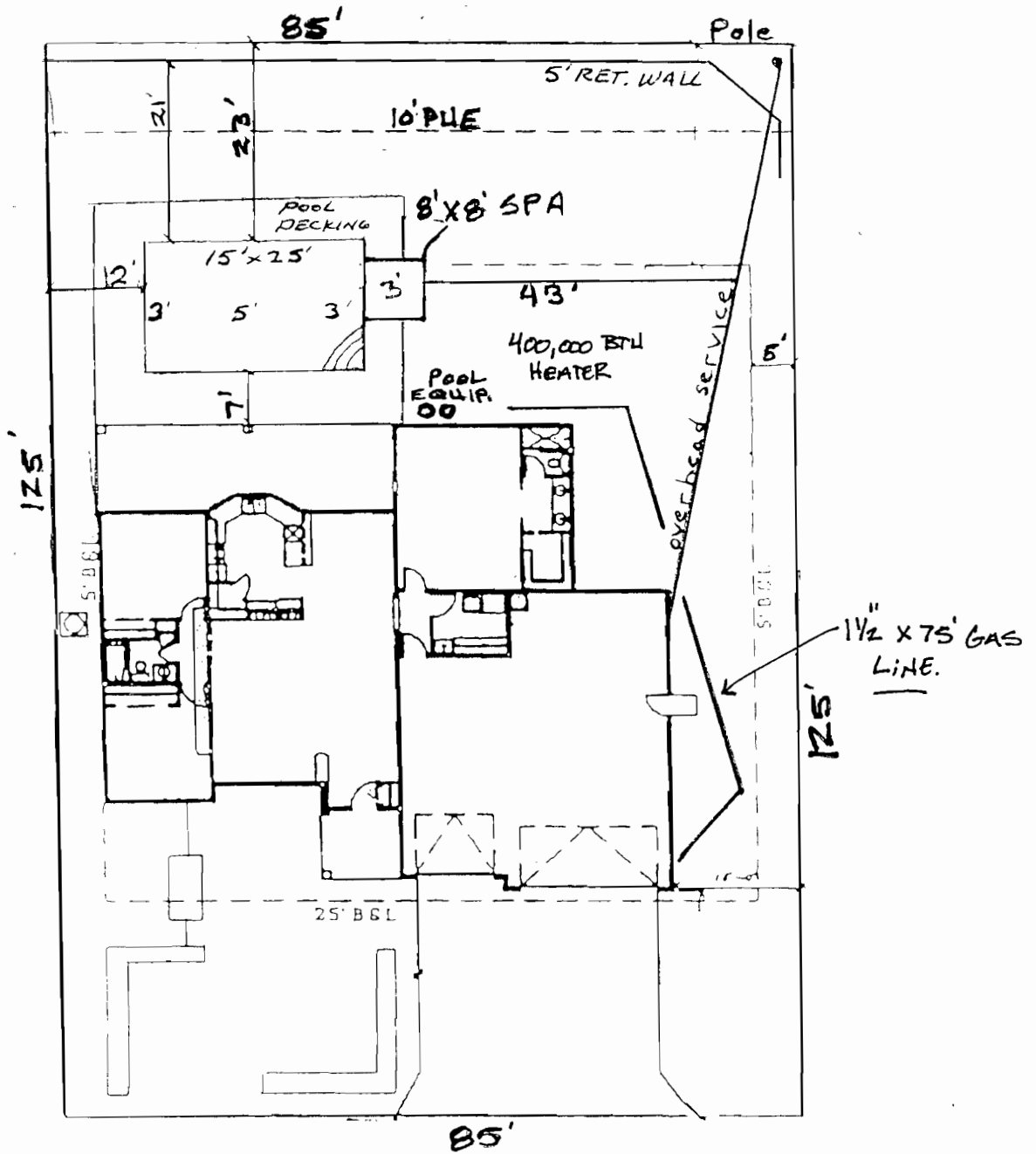

SEASIDE DR.

SITE PLAN

SCALE 1"=10'-0"

2310 SEASIDE DR.

- TRACT \_\_\_\_\_
- BLOCK \_\_\_\_\_
- LOT \_\_\_\_\_

Pool/SPA SAMPLE