

Contractor: Pioneer Earthmovers
 Agency: Lake Havasu City
 Project: Roadway Improvements
 Project Name: Street Pavement Priority Program -
 Mesquite Ave & Lake Havasu Ave
 Location: Mesquite Ave @ Civic Center Ln
 Start Date: ____-____-____
 End Date: ____-____-____
 Working Hours: 9:00 pm to 11:00 pm
 Contact: Tony - 928.727.2250

ROAD CLOSURE
 NIGHT WORK ONLY

NORTH 



QUAIL
CONSTRUCTION
 4166 KATHY EAST, FORT MOHAVE, AZ 86426

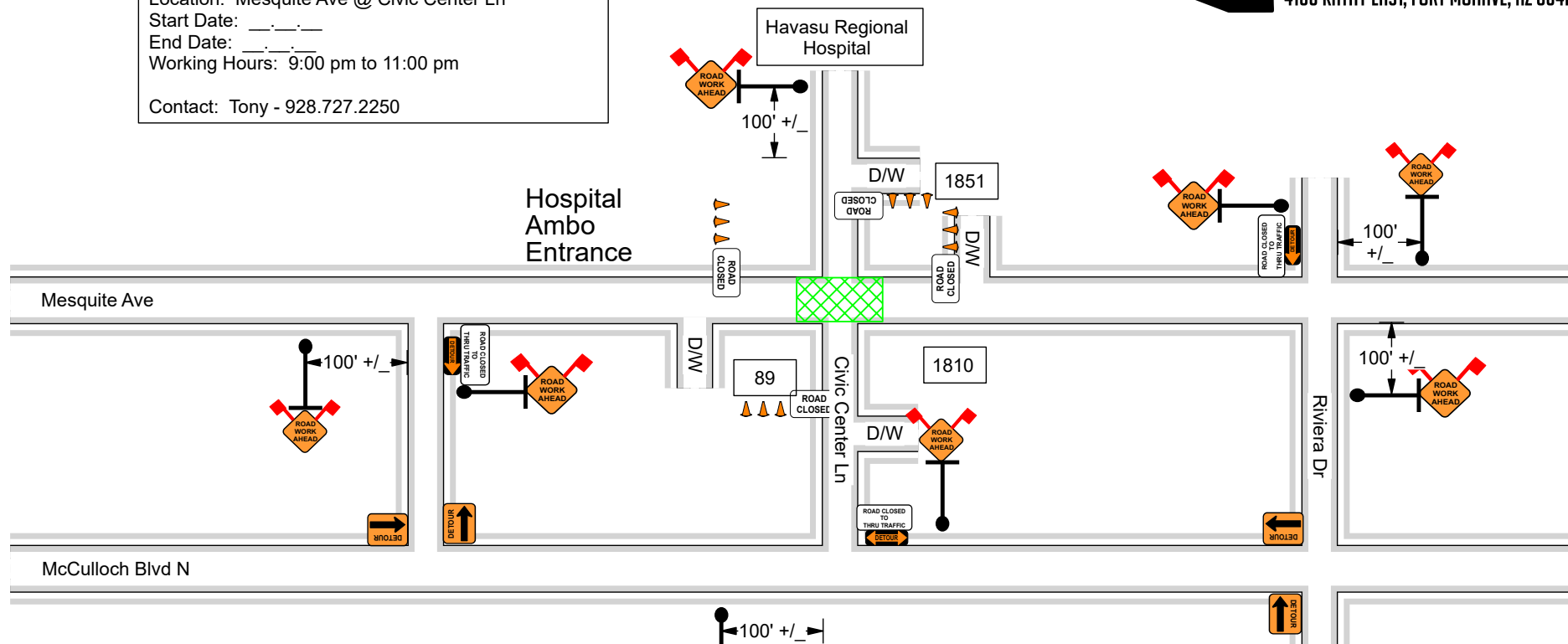

ADDITIONAL NOTES:

***FLAG PERSONS TO BE PLACED AT EACH END OF CIVIC CENTER LN, MC CULLOCH & MESQUITE AND LOWER ENTRANCE
 ***THE PARIAL ROAD CLOSURE IS TO ALLOW EMERGENCY VEHICLES TO ACCESS THE HOSPITAL

SPACING:

Traffic Cone, 28" (retro-reflective):
 5 feet

PLAN NOT TO SCALE
 FIELD ADJUSTMENTS TO BE MADE AS NEEDED

ALL ITEMS TO BE BAGGED AND FLAGGED AS REQUIRED

ATSSA CERTIFICATION #'S
 TOM NORMAN - #35721 - EXP - 09.28.2028
 NANCY NORMAN - #35723 - EXP - 09.28.2028
 TODD COOK - #600253 - EXP - 12.17.2025
 IAN DIAZ - #1010397 - EXP - 06.11.2027

NOTES: The Traffic Control Plan is based on Quail Construction, LLC being responsible for the delivery and placement, as well as the final removal of the Traffic Control Devices. Pioneer Earthmovers will be responsible for the daily teardowns, daily resets, maintenance, as well as the final teardown of the Traffic Control Devices..

PREPARED BY:

Nancy Norman
 nnorman@quailcorp.com
 Quail Construction, LLC
 02.18.25
 928.768.7233 - phone / 928.444.3303 - cell

TCP #: QCFM-25.0123